

EZ LOK

THREADED INSERTS



FOR STRONG THREADS IN:

METAL

WOOD

PLASTIC



**THREADED INSERTS
FOR METAL**

| | |
|---|---|
| INSTALLATION | 3 |
| CARBON STEEL | 4 |
| CARBON STEEL (METRIC) | 5 |
| STAINLESS (UNC/UNF/METRIC) .. | 6 |
| PREPACKAGED THREADED INSERT KITS | 7 |

**ULTRASONIC INSERTS
FOR THERMOPLASTICS**

| | |
|----------------|---|
| TAPERED | 8 |
| STRAIGHT | 9 |

**PRESS INSERTS FOR THERMOSET PLASTICS** 10**KNIFE THREAD INSERTS FOR HARD WOOD** 11**HEX DRIVE INSERTS FOR SOFT WOOD** 11**FINSERTS FOR SOFT WOOD AND PLASTIC** 12

STRONG THREADS MADE EASY

ALL E-Z LOK INSERTS INSTALL WITH STANDARD TOOLS
NO SPECIAL DRILLS... NO SPECIAL TAPS... NO SPECIAL INSTALLATION TOOLS

E-Z LOK external threads are standard size and pitch to permit use of standard drills and taps. No special tap sizes or installation tools are required.

E-Z LOK inserts will not back out or vibrate loose. Immediately upon installation, microencapsulated adhesive begins to set and the newly installed insert can be fastened to within minutes. In addition, the adhesive seals against liquids and gases to pressures of 6,000 psi, and bonds to virtually all metals.

EASY REMOVAL Use a standard screw and bolt extractor to back out a damaged insert and then replace it with a new insert. Removal is simply a matter of overcoming the resistance to torque-out which has been produced by the thread locking material.



Power drive tools are available for high volume installation... See insert tables for catalog numbers and sizes.



WHAT'S THE DIFFERENCE?



Q: What's the difference between E-Z LOK and coil threaded inserts?

A: There are two primary differences: design and installation.

Design

As the name implies, coil inserts are steel wire coiled in a spring-like design. E-Z LOK threaded inserts are screw machined out of solid steel.

Installation

To install a coil insert, you must have a special drill, special tap, and special installation tool. If a tap breaks or the installation tool is misplaced, the coil inserts can't be installed until a new tap or installation tool is purchased. E-Z LOK threaded inserts have standard size/pitch threads so they can be installed using standard tools probably already in your toolbox. For example, to install an E-Z LOK 329-5 (which has a 1/2-13 external thread), you would simply drill the hole with a standard 27/64 drill and then tap the hole with a standard 1/2-13 tap. Once that's done, the insert is threaded into the hole like an ordinary fastener using a screwdriver, bolt and jam nut, or an E-Z LOK drive tool.

COARSE THREAD SIZES

| EZ-LOK Part No. | Internal Thread | External Thread | Length in. | Tap Drill Size | Tap Size | Minimum Full Thread Depth | Drive Tool Catalog No. |
|-----------------|-----------------|-----------------|------------|----------------|----------|---------------------------|------------------------|
| 329-004 | 4-40 | 10-32 | .250 | 5/32 | 10-32 | 9/32 | — |
| 329-006 | 6-32 | 1/4-20 | .280 | 7 | 1/4-20 | 11/32 | 500-006 |
| 329-008 | 8-32 | 5/16-18 | .290 | F | 5/16-18 | 7/16 | 500-1 |
| 329-3 | 10-24 | 3/8-16 | .406 | 5/16 | 3/8-16 | 15/32 | 500-2 |
| 329-4 | 1/4-20 | 7/16-14 | .437 | 23/64 | 7/16-14 | 1/2 | 500-3 |
| 329-5 | 5/16-18 | 1/2-13 | .484 | 27/64 | 1/2-13 | 9/16 | 500-4 |
| 329-6 | 3/8-16 | 9/16-12 | .515 | 31/64 | 9/16-12 | 19/32 | 500-5 |
| 329-7 | 7/16-14 | 5/8-11 | .656 | 17/32 | 5/8-11 | 23/32 | 500-6 |
| 329-8 | 1/2-13 | 3/4-10 | .656 | 21/32 | 3/4-10 | 3/4 | 500-7 |
| 329-801 | 1/2-13 | 3/4-10 | 1.000 | 21/32 | 3/4-10 | 3/4 | 500-7 |
| 329-9 | 9/16-12 | 3/4-10 | .656 | 21/32 | 3/4-10 | 3/4 | 500-7 |
| 329-10 | 5/8-11 | 7/8-9 | .687 | 49/64 | 7/8-9 | 13/16 | 500-8 |
| 329-1018 | 5/8-11 | 7/8-9 | 1.125 | 49/64 | 7/8-9 | 1-1/4 | 500-8 |
| 329-12 | 3/4-10 | 1-8 | .781 | 7/8 | 1-8 | 7/8 | 500-9 |
| 329-14 | 7/8-9 | 1-1/4-7 | 1.125 | 1-7/64 | 1-1/4-7 | 1-1/4 | — |
| 329-16 | 1-8 | 1-3/8-12 | 1.250 | 1-9/32 | 1-3/8-12 | 1-3/8 | — |

FINE THREAD SIZES

| EZ-LOK Part No. | Internal Thread | External Thread | Length in. | Tap Drill Size | Tap Size | Minimum Full Thread Depth | Drive Tool Catalog No. |
|-----------------|-----------------|-----------------|------------|----------------|----------|---------------------------|------------------------|
| 329-332 | 10-32 | 3/8-16 | .406 | 5/16 | 3/8-16 | 15/32 | 500-2 |
| 329-428 | 1/4-28 | 7/16-14 | .437 | 23/64 | 7/16-14 | 1/2 | 500-3 |
| 329-524 | 5/16-24 | 1/2-13 | .484 | 27/64 | 1/2-13 | 9/16 | 500-4 |
| 329-624 | 3/8-24 | 9/16-12 | .515 | 31/64 | 9/16-12 | 19/32 | 500-5 |
| 329-720 | 7/16-20 | 5/8-11 | .656 | 17/32 | 5/8-11 | 23/32 | 500-6 |
| 329-820 | 1/2-20 | 3/4-10 | .656 | 21/32 | 3/4-10 | 3/4 | 500-7 |
| 329-918 | 9/16-18 | 3/4-10 | .656 | 21/32 | 3/4-10 | 3/4 | 500-7 |
| 329-10F | 5/8-18 | 7/8-9 | .687 | 49/64 | 7/8-9 | 13/16 | 500-8 |
| 329-1216 | 3/4-16 | 1-8 | .781 | 7/8 | 1-8 | 7/8 | 500-9 |
| 329-1414 | 7/8-14 | 1-1/4-7 | 1.125 | 1-7/64 | 1-1/4-7 | 1-1/4 | — |
| 329-1614 | 1-14 | 1-3/8-12 | 1.250 | 1-9/32 | 1-3/8-12 | 1-3/8 | — |

THIN WALL — COARSE THREAD SIZES

| EZ-LOK Part No. | Internal Thread | External Thread | Length in. | Tap Drill Size | Tap Size | Minimum Full Thread Depth | Drive Tool Catalog No. |
|-----------------|-----------------|-----------------|------------|----------------|----------|---------------------------|------------------------|
| 319-3 | 10-24 | 5/16-18 | .312 | I | 5/16-18 | .375 | 500-2 |
| 319-4 | 1/4-20 | 3/8-16 | .375 | Q | 3/8-16 | .437 | 500-3 |
| 319-5 | 5/16-18 | 7/16-14 | .437 | X | 7/16-14 | .500 | 500-4 |
| 319-6 | 3/8-16 | 1/2-13 | .500 | 29/64 | 1/2-13 | .560 | 500-5 |
| 319-7 | 7/16-14 | 9/16-12 | .560 | 33/64 | 9/16-12 | .620 | 500-6 |
| 319-8 | 1/2-13 | 5/8-11 | .620 | 37/64 | 5/8-11 | .680 | 500-7 |

THIN WALL — FINE THREAD SIZES

| EZ-LOK Part No. | Internal Thread | External Thread | Length in. | Tap Drill Size | Tap Size | Minimum Full Thread Depth | Drive Tool Catalog No. |
|-----------------|-----------------|-----------------|------------|----------------|----------|---------------------------|------------------------|
| 319-332 | 10-32 | 5/16-18 | .312 | I | 5/16-18 | .375 | 500-2 |
| 319-428 | 1/4-28 | 3/8-16 | .375 | Q | 3/8-16 | .437 | 500-3 |
| 319-524 | 5/16-24 | 7/16-14 | .437 | X | 7/16-14 | .500 | 500-4 |
| 319-624 | 3/8-24 | 1/2-13 | .500 | 29/64 | 1/2-13 | .560 | 500-5 |
| 319-720 | 7/16-20 | 9/16-12 | .560 | 33/64 | 9/16-12 | .620 | 500-6 |
| 319-820 | 1/2-20 | 5/8-11 | .620 | 37/64 | 5/8-11 | .680 | 500-7 |

EXTRA HEAVY WALL — COARSE THREAD SIZES

| EZ-LOK Part No. | Internal Thread | External Thread | Length in. | Tap Drill Size | Tap Size | Minimum Full Thread Depth | Drive Tool Catalog No. |
|-----------------|-----------------|-----------------|------------|----------------|----------|---------------------------|------------------------|
| 335-4 | 1/4-20 | 1/2-13 | .484 | 27/64 | 1/2-13 | 9/16 | 500-3 |
| 335-5 | 5/16-18 | 9/16-12 | .515 | 31/64 | 9/16-12 | 19/32 | 500-4 |
| 335-6 | 3/8-16 | 5/8-11 | .656 | 17/32 | 5/8-11 | 23/32 | 500-5 |
| 335-8 | 1/2-13 | 7/8-9 | .687 | 49/64 | 7/8-9 | 13/16 | — |
| 335-10 | 5/8-11 | 1-8 | .781 | 7/8 | 1-8 | 7/8 | — |

METRIC THREAD SIZES — METRIC INTERNAL/METRIC EXTERNAL

| EZ-LOK Part No. | Internal Thread | External Thread | Length | Tap Drill Size | Tap Size | Minimum Full Thread Depth | Drive Tool Catalog No. |
|-----------------|-----------------|-----------------|--------|----------------|----------|---------------------------|------------------------|
| 450-3 | M3-0.5 | M6-1.0 | 6.5mm | 5.1mm | M6-1.0 | 7.8mm | — |
| 450-4 | M4-0.7 | M8-1.25 | 7.5mm | 6.9mm | M8-1.25 | 9.0mm | 500-1 |
| 450-5 | M5-0.8 | M8-1.25 | 7.5mm | 6.9mm | M8-1.25 | 9.0mm | 500-1 |
| 450-6 | M6-1.0 | M10-1.5 | 10.5mm | 8.6mm | M10-1.5 | 12.0mm | 500-3 |
| 450-8 | M8-1.25 | M12-1.75 | 12.5mm | 10.4mm | M12-1.75 | 14.5mm | 500-4 |
| 450-10 | M10-1.5 | M16-2.0 | 17.0mm | 14.0mm | M16-2.0 | 19.0mm | 500-5 |
| 450-12 | M12-1.75 | M16-2.0 | 17.0mm | 14.0mm | M16-2.0 | 19.0mm | 500-6 |
| 450-16 | M16-2.0 | M24-3.0 | 20.0mm | 21.0mm | M24-3.0 | 24.0mm | 500-8 |
| 450-20 | M20-2.5 | M36-4.0 | 30.0mm | 33.0mm | M36-4.0 | 35.0mm | — |

METRIC THREAD SIZES — U.S. INTERNAL/METRIC EXTERNAL

| EZ-LOK Part No. | Internal Thread | External Thread | Length | Tap Drill Size | Tap Size | Minimum Full Thread Depth | Drive Tool Catalog No. |
|-----------------|-----------------|-----------------|---------|----------------|----------|---------------------------|------------------------|
| 550-006 | 6-32 | M6-1.0 | 6.5 mm | 5.1mm | M6-1.0 | 7.8mm | — |
| 550-008 | 8-32 | M8-1.25 | 7.5 mm | 6.9mm | M8-1.25 | 9.0mm | 500-1 |
| 550-1024 | 10-24 | M8-1.25 | 7.5 mm | 6.9mm | M8-1.25 | 12.0mm | 500-2 |
| 550-1032 | 10-32 | M8-1.25 | 7.5 mm | 6.9mm | M8-1.25 | 12.0mm | 500-2 |
| 550-1420 | 1/4-20 | M10-1.5 | 10.5 mm | 8.6mm | M10-1.5 | 14.5mm | 500-3 |
| 550-5 | 5/16-18 | M12-1.75 | 12.5 mm | 10.4mm | M12-1.75 | 14.5mm | 500-4 |
| 550-6 | 3/8-16 | M16-2.0 | 17.0 mm | 14.0mm | M16-2.0 | 19.0mm | 500-5 |
| 550-8 | 1/2-13 | M16-2.0 | 17.0 mm | 14.0mm | M16-2.0 | 19.0mm | 500-7 |

METRIC THREAD SIZES — METRIC INTERNAL/U.S. EXTERNAL

| EZ-LOK Part No. | Internal Thread | External Thread | Length | Tap Drill Size | Tap Size | Minimum Full Thread Depth | Drive Tool Catalog No. |
|-----------------|-----------------|-----------------|--------|----------------|----------|---------------------------|------------------------|
| 650-6 | M6-1.0 | 3/8-16 | .406 | 5/16 | 3/8-16 | 15/32 | 500-3 |
| 650-8 | M8-1.25 | 1/2-13 | .484 | 27/64 | 1/2-13 | 9/16 | 500-4 |
| 65010 | M10-1.50 | 9/16-12 | .515 | 31/64 | 9/16-12 | 19/32 | 500-5 |
| 650-10F | M10-1.25 | 9/16-12 | .515 | 31/64 | 9/16-12 | 19/32 | 500-5 |
| 650-12 | M12-1.75 | 3/4-10 | .656 | 21/32 | 3/4-10 | 3/4 | 500-6 |
| 650-14 | M14-2.0 | 7/8-9 | .687 | 49/64 | 7/8-9 | 13/16 | 500-7 |
| 650-16 | M16-2.0 | 1-8 | .781 | 7/8 | 1-8 | 7-8 | 500-8 |

AUTOMOTIVE DESIGNS

| EZ-LOK Part No. | Internal Thread | External Thread | Length | Tap Drill Size | Tap Size | |
|-------------------------|-----------------|-----------------|--------|----------------|----------|--|
| SPARK PLUG SIZES | | | | | | |
| 329-1008 | M10-1.0 | 9/16-18 | .453 | 33/64 | 9/16-18 | |
| 329-1208 | M12-1.25 | 5/8-18 | .453 | 37/64 | 5/8-18 | |
| 329-1212 | M12-1.25 | 5/8-18 | .703 | 37/64 | 5/8-18 | |
| 750-14 | M14-1.25 | M18-1.5 | 11.5mm | 16.5mm | M18-1.5 | |
| 329-1406 | M14-1.25 | 3/4-16 | .328 | 11/16 | 3/4-16 | |
| 329-1408 | M14-1.25 | 3/4-16 | .453 | 11/16 | 3/4-16 | |
| 329-1412 | M14-1.25 | 3/4-16 | .703 | 11/16 | 3/4-16 | |
| 329-1808 | M18-1.5 | 1-12 | .453 | 59/64 | 1-12 | |
| VW CASE SAVERS | | | | | | |
| 330-10 (Open) | M10-1.50 | 9/16-12 | 1.000 | 31/64 | 9/16-12 | |
| 330-11 (Closed) | M10-1.50 | 9/16-12 | 1.000 | 31/64 | 9/16-12 | |

COARSE THREAD SIZES IN STAINLESS STEEL

| EZ-LOK Part No. | Internal Thread | External Thread | Length in. | Tap Drill Size | Tap Size | Minimum Full Thread Depth | Drive Tool Catalog No. |
|-----------------|-----------------|-----------------|------------|----------------|----------|---------------------------|------------------------|
| 303-004 | 4-40 | 10-32 | .250 | 5/32 | 10-32 | 9/32 | — |
| 303-006 | 6-32 | 1/4-20 | .280 | 7 | 1/4-20 | 11/32 | — |
| 303-008 | 8-32 | 5/16-18 | .290 | F | 5/16-18 | 7/16 | 500-1 |
| 303-3 | 10-24 | 3/8-16 | .406 | 5/16 | 3/8-16 | 15/32 | 500-2 |
| 303-4 | 1/4-20 | 7/16-14 | .437 | 23/64 | 7/16-14 | 1/2 | 500-3 |
| 303-5 | 5/16-18 | 1/2-13 | .484 | 27/64 | 1/2-13 | 9/16 | 500-4 |
| 303-6 | 3/8-16 | 9/16-12 | .515 | 31/64 | 9/16-12 | 19/32 | 500-5 |
| 303-7 | 7/16-14 | 5/8-11 | .656 | 17/32 | 5/8-11 | 23/32 | 500-6 |
| 303-8 | 1/2-13 | 3/4-10 | .656 | 21/32 | 3/4-10 | 3/4 | 500-7 |
| 303-10 | 5/8-11 | 7/8-9 | .687 | 49/64 | 7/8-9 | 13/16 | 500-8 |
| 303-12 | 3/4-10 | 1-8 | .781 | 7/8 | 1-8 | 7/8 | 500-9 |

FINE THREAD SIZES IN STAINLESS STEEL

| EZ-LOK Part No. | Internal Thread | External Thread | Length in. | Tap Drill Size | Tap Size | Minimum Full Thread Depth | Drive Tool Catalog No. |
|-----------------|-----------------|-----------------|------------|----------------|----------|---------------------------|------------------------|
| 303-332 | 10-32 | 3/8-16 | .406 | 5/16 | 3/8-16 | 15/32 | 500-2 |
| 303-428 | 1/4-28 | 7/16-14 | .437 | 23/64 | 7/16-14 | 1/2 | 500-3 |
| 303-524 | 5/16-24 | 1/2-13 | .484 | 27/64 | 1/2-13 | 9/16 | 500-4 |
| 303-624 | 3/8-24 | 9/16-12 | .515 | 31/64 | 9/16-12 | 19/32 | 500-5 |
| 303-720 | 7/16-20 | 5/8-11 | .656 | 17/32 | 5/8-11 | 23/32 | 500-6 |
| 303-820 | 1/2-20 | 3/4-10 | .656 | 21/32 | 3/4-10 | 3/4 | 500-7 |

METRIC THREAD SIZES IN STAINLESS STEEL — METRIC INTERNAL/METRIC EXTERNAL

| EZ-LOK Part No. | Internal Thread | External Thread | Length | Tap Drill Size | Tap Size | Minimum Full Thread Depth | Drive Tool Catalog No. |
|-----------------|-----------------|-----------------|--------|----------------|----------|---------------------------|------------------------|
| 453-3 | M3-0.5 | M6-1.0 | 6.5mm | 5.1mm | M6-1.0 | 7.8mm | — |
| 453-4 | M4-0.7 | M8-1.25 | 7.5mm | 6.9mm | M8-1.25 | 9.0mm | 500-1 |
| 453-5 | M5-0.8 | M8-1.25 | 7.5mm | 6.9mm | M8-1.25 | 9.0mm | 500-1 |
| 453-6 | M6-1.0 | M10-1.5 | 10.5mm | 8.6mm | M10-1.5 | 12.0mm | 500-3 |
| 453-8 | M8-1.25 | M12-1.75 | 12.5mm | 10.4mm | M12-1.75 | 14.5mm | 500-4 |
| 453-10 | M10-1.5 | M16-2.0 | 17.0mm | 14.0mm | M16-2.0 | 19.0mm | 500-5 |
| 453-12 | M12-1.75 | M16-2.0 | 17.0mm | 14.0mm | M16-2.0 | 19.0mm | 500-6 |
| 453-16 | M16-2.0 | M24-3.0 | 20.0mm | 21.0mm | M24-3.0 | 24.0mm | 500-8 |

METRIC THREAD SIZES IN STAINLESS STEEL — METRIC INTERNAL/U.S. EXTERNAL

| EZ-LOK Part No. | Internal Thread | External Thread | Length | Tap Drill Size | Tap Size | Minimum Full Thread Depth | Drive Tool Catalog No. |
|-----------------|-----------------|-----------------|--------|----------------|----------|---------------------------|------------------------|
| 653-6 | M6-1.0 | 3/8-16 | .406 | 5/16 | 3/8-16 | 15/32 | 500-3 |
| 653-8 | M8-1.25 | 1/2-13 | .484 | 27/64 | 1/2-13 | 9/16 | 500-4 |
| 653-10 | M10-1.50 | 9/16-12 | .515 | 31/64 | 9/16-12 | 19/32 | 500-5 |
| 653-10F | M10-1.25 | 9/16-12 | .515 | 31/64 | 9/16-12 | 19/32 | 500-5 |
| 653-12 | M12-1.75 | 3/4-10 | .656 | 21/32 | 3/4-10 | 3/4 | 500-6 |
| 653-14 | M14-2.0 | 7/8-9 | .687 | 49/64 | 7/8-9 | 13/16 | 500-7 |
| 653-16 | M16-2.0 | 1-8 | .781 | 7/8 | 1-8 | 7/8 | 500-8 |

INSTALLATION VIDEO



VISIT OUR WEBSITE AT WWW.EZLOK.COM TO VIEW A VIDEO DEMONSTRATING THE EASY 1-2-3 INSTALLATION OF E-Z LOK THREADED INSERTS



Prepackaged kits containing a range of sizes are available.

Note: Because E-Z LOK inserts install with standard tools, our kits contain only inserts. Drills and taps are not included.

| CARBON STEEL THREAD INSERTS FOR METAL | | | | | |
|---------------------------------------|------------|---------------------|--------------------|-----------------|-----------------|
| Kit Type | Kit Number | Quantity of Inserts | Insert Part Number | Internal Thread | External Thread |
| Coarse Thread #10 to 7/16" | EZ C107 | 10 | 329-3 | 10-24 | 3/8-16 |
| | | 10 | 329-4 | 1/4-20 | 7/16-14 |
| | | 10 | 329-5 | 5/16-18 | 1/2-13 |
| | | 10 | 329-6 | 3/8-16 | 9/16-12 |
| | | 8 | 329-7 | 7/16-14 | 5/8-11 |
| Coarse Thread #10 to 1/2" | EZ C108 | 10 | 329-3 | 10-24 | 3/8-16 |
| | | 10 | 329-4 | 1/4-20 | 7/16-14 |
| | | 10 | 329-5 | 5/16-18 | 1/2-13 |
| | | 10 | 329-6 | 3/8-16 | 9/16-12 |
| | | 6 | 329-8 | 1/2-13 | 3/4-10 |
| Coarse Thread 1/2" to 1" | EZ C816 | 6 | 329-8 | 1/2-13 | 3/4-10 |
| | | 7 | 329-10 | 5/8-11 | 7/8-9 |
| | | 7 | 329-12 | 3/4-10 | 1-8 |
| | | 2 | 329-16 | 1-8 | 1-3/8-12 |
| Fine Thread #10 to 7/16" | EZ F107 | 10 | 329-332 | 10-32 | 3/8-16 |
| | | 10 | 329-428 | 1/4-28 | 7/16-14 |
| | | 10 | 329-524 | 5/16-24 | 1/2-13 |
| | | 8 | 329-720 | 7/16-20 | 5/8-11 |
| Fine Thread #10 to 1/2" | EZ F108 | 10 | 329-332 | 10-32 | 3/8-16 |
| | | 10 | 329-428 | 1/4-28 | 7/16-14 |
| | | 10 | 329-524 | 5/16-24 | 1/2-13 |
| | | 6 | 329-820 | 1/2-20 | 3/4-10 |
| Fine Thread 1/2" to 1" | EZ F816 | 6 | 329-820 | 1/2-20 | 3/4-10 |
| | | 7 | 329-10F | 5/8-18 | 7/8-9 |
| | | 7 | 329-1216 | 3/4-16 | 1-8 |
| | | 2 | 329-1614 | 1-14 | 1-3/8-12 |

| CARBON STEEL THREAD INSERTS FOR METAL — METRIC | | | | | |
|--|------------|---------------------|--------------------|-----------------|-----------------|
| Kit Type | Kit Number | Quantity of Inserts | Insert Part Number | Internal Thread | External Thread |
| M3-0.5 to M8-1.25 | EZ M100 | 10 | 450-3 | M3-0.5 | M6-1.0 |
| | | 10 | 450-4 | M4-0.7 | M8-1.25 |
| | | 10 | 450-5 | M5-0.8 | M8-1.25 |
| | | 10 | 450-6 | M6-1.0 | M10-1.5 |
| | | 10 | 450-8 | M8-1.25 | M12-1.75 |
| M8-1.25 to M16-2.0 | EZ M200 | 10 | 450-8 | M8-1.25 | M12-1.75 |
| | | 10 | 450-10 | M10-1.5 | M16-2.0 |
| | | 8 | 450-12 | M12-1.75 | M16-2.0 |
| | | 5 | 450-16 | M16-2.0 | M24-3.0 |
| Coarse Thread #10 to 1/2" | EZ M508 | 10 | 550-3 | 10-24 | M10-1.5 |
| | | 10 | 550-4 | 1/4-20 | M12-1.75 |
| | | 10 | 550-5 | 5/16-18 | M12-1.75 |
| | | 10 | 550-6 | 3/8-16 | M16-2.0 |
| | | 6 | 550-8 | 1/2-13 | M16-2.0 |
| Metric Thread M6 to M12 | EZ M612 | 10 | 650-6 | M6-1.0 | 3/8-16 |
| | | 10 | 650-8 | M8-1.25 | 1/2-13 |
| | | 10 | 650-10 | M10-1.5 | 9/16-12 |
| | | 6 | 650-12 | M12-1.75 | 3/4-10 |

| STAINLESS STEEL THREAD INSERTS FOR METAL | | | | | |
|--|------------|---------------------|--------------------|-----------------|-----------------|
| Kit Type | Kit Number | Quantity of Inserts | Insert Part Number | Internal Thread | External Thread |
| Coarse Thread 303 Stainless #10 to 1/2" | EZ C303 | 10 | 303-3 | 10-24 | 3/8-16 |
| | | 10 | 303-4 | 1/4-20 | 7/16-14 |
| | | 10 | 303-5 | 5/16-18 | 1/2-13 |
| | | 10 | 303-6 | 3/8-16 | 9/16-12 |
| | | 6 | 303-8 | 1/2-13 | 3/4-10 |
| Fine Thread 303 Stainless #10 to 1/2" | EZ F303 | 10 | 303-332 | 10-32 | 3/8-16 |
| | | 10 | 303-428 | 1/4-28 | 7/16-14 |
| | | 10 | 303-524 | 5/16-24 | 1/2-13 |
| | | 6 | 303-820 | 1/2-20 | 3/4-10 |
| M3-0.5 to M8-1.25 | EZ M103 | 10 | 453-3 | M3-0.5 | M6-1.0 |
| | | 10 | 453-4 | M4-0.7 | M8-1.25 |
| | | 10 | 453-5 | M5-0.8 | M8-1.25 |
| | | 10 | 453-6 | M6-1.0 | M10-1.5 |
| | | 10 | 453-8 | M8-1.25 | M12-1.75 |
| M8-1.25 to M16-2.0 | EZ M203 | 10 | 453-8 | M8-1.25 | M12-1.75 |
| | | 10 | 453-10 | M10-1.5 | M16-2.0 |
| | | 8 | 453-12 | M12-1.75 | M16-2.0 |
| | | 5 | 453-16 | M16-2.0 | M24-3.0 |
| Metric Thread M6 to M12 | EZ M613 | 10 | 653-6 | M6-1.0 | 3/8-16 |
| | | 10 | 653-8 | M8-1.25 | 1/2-13 |
| | | 10 | 653-10 | M10-1.5 | 9/16-12 |
| | | 6 | 653-12 | M12-1.75 | 3/4-10 |

ULTRASONIC INSERTS—TAPERED

DESIGNED FOR USE IN THERMOPLASTICS

- TAPERED DESIGN REDUCES INSTALLATION TIME
- INSTALL ULTRASONICALLY OR WITH HEAT DRIVER
- SUPERIOR TORQUE/PULL OUT RESISTANCE
- UNC AND METRIC THREADS
- SINGLE AND DOUBLE VANE



TAPERED SINGLE VANE

| Part Number. | Internal Thread | Overall Length (L) | Insert Diameter (W) | Pilot Diameter (N) | Rec. Hole Size* (D) | Rec. Hole Size* (S) | Minimum Wall Thickness |
|--------------|-----------------|--------------------|---------------------|--------------------|---------------------|---------------------|------------------------|
| TH-002-SV | 2-56 | .115 | .136 | .122 | .123 | .118 | .080 |
| TH-004-SV | 4-40 | .135 | .172 | .157 | .159 | .153 | .093 |
| TH-006-SV | 6-32 | .150 | .220 | .203 | .206 | .199 | .116 |
| TH-008-SV | 8-32 | .185 | .250 | .230 | .234 | .226 | .133 |
| TH-124-SV | 10-24 | .225 | .296 | .272 | .277 | .267 | .159 |
| TH-132-SV | 10-32 | .225 | .296 | .272 | .277 | .267 | .159 |
| TH-420-SV | 1/4-20 | .300 | .375 | .354 | .363 | .349 | .194 |
| TH-428-SV | 1/4-28 | .300 | .375 | .354 | .363 | .349 | .194 |
| TH-518-SV | 5/16-18 | .335 | .469 | .439 | .448 | .431 | .245 |
| TH-316-SV | 3/8-16 | .375 | .563 | .530 | .540 | .523 | .293 |
| TH-324-SV | 3/8-24 | .375 | .563 | .530 | .540 | .523 | .293 |
| TH-M25-SV | M2.5-0.4 | .135 | .172 | .157 | .159 | .153 | .093 |
| TH-M30-SV | M3-0.5 | .150 | .220 | .203 | .206 | .199 | .116 |
| TH-M40-SV | M4-0.7 | .185 | .250 | .230 | .234 | .226 | .133 |
| TH-M50-SV | M5-0.8 | .265 | .328 | .308 | .315 | .303 | .171 |
| TH-M60-SV | M6-1.0 | .300 | .375 | .354 | .363 | .349 | .194 |

* Hole size requirements may vary depending on a number of factors, including material and tools. We recommend that you test your particular application before ordering. We gladly supply free samples.

TAPERED DOUBLE VANE

| Part Number. | Internal Thread | Overall Length (L) | Insert Diameter (W) | Pilot Diameter (N) | Rec. Hole Size* (D) | Rec. Hole Size* (S) | Minimum Wall Thickness |
|--------------|-----------------|--------------------|---------------------|--------------------|---------------------|---------------------|------------------------|
| DV-002-TH | 2-56 | .188 | .136 | .115 | .123 | .107 | .080 |
| DV-004-TH | 4-40 | .219 | .172 | .144 | .159 | .141 | .093 |
| DV-006-TH | 6-32 | .250 | .220 | .190 | .206 | .185 | .116 |
| DV-008-TH | 8-32 | .312 | .250 | .212 | .234 | .208 | .133 |
| DV-124-TH | 10-24 | .375 | .297 | .251 | .277 | .246 | .159 |
| DV-132-TH | 10-32 | .375 | .297 | .251 | .277 | .246 | .159 |
| DV-420-TH | 1/4-20 | .500 | .375 | .332 | .363 | .321 | .194 |
| DV-428-TH | 1/4-28 | .500 | .375 | .332 | .363 | .321 | .194 |
| DV-518-TH | 5/16-18 | .562 | .469 | .406 | .448 | .401 | .245 |
| DV-316-TH | 3/8-16 | .625 | .563 | .493 | .540 | .488 | .293 |
| DV-M25-TH | M2.5-0.4 | .219 | .172 | .144 | .159 | .141 | .093 |
| DV-M30-TH | M3-0.5 | .250 | .220 | .190 | .206 | .185 | .116 |
| DV-M40-TH | M4-0.7 | .312 | .250 | .212 | .234 | .208 | .133 |
| DV-M50-TH | M5-0.8 | .438 | .328 | .283 | .315 | .278 | .171 |
| DV-M60-TH | M6-1.0 | .500 | .375 | .332 | .363 | .321 | .194 |

* Hole size requirements may vary depending on a number of factors, including material and tools. We recommend that you test your particular application before ordering. We gladly supply free samples.

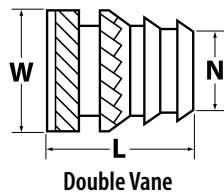
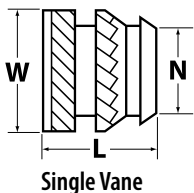

Hole depth should be a minimum of .030" greater than the length of the insert in blind holes.

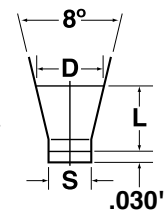

ULTRASONIC INSERTS—STRAIGHT

DESIGNED FOR USE IN THERMOPLASTICS

- STRAIGHT DESIGN PERMITS THINNER BOSS WALLS
- INSTALL ULTRASONICALLY OR WITH HEAT DRIVER
- SUPERIOR TORQUE/PULL OUT RESISTANCE
- FLUSH AND FLANGED DESIGNS



STRAIGHT FLUSH

| Part Number. | Internal Thread | Overall Length (L) | Insert Diameter (W) | Head Diameter (H) | Pilot Diameter (N) | Rec. Hole Size* | Minimum Wall Thickness |
|--------------|-----------------|--------------------|---------------------|-------------------|--------------------|-----------------|------------------------|
| HI-002-WH | 2-56 | .157 | .141 | N/A | .123 | .126 | .051 |
| HI-004-WH | 4-40 | .226 | .181 | N/A | .154 | .157 | .063 |
| HI-006-WH | 6-32 | .281 | .214 | N/A | .185 | .189 | .071 |
| HI-008-WH | 8-32 | .321 | .248 | N/A | .218 | .220 | .083 |
| HI-124-WH | 10-24 | .375 | .278 | N/A | .249 | .252 | .102 |
| HI-132-WH | 10-32 | .375 | .278 | N/A | .249 | .252 | .102 |
| HI-420-WH | 1/4-20 | .500 | .341 | N/A | .312 | .315 | .130 |
| HI-428-WH | 1/4-28 | .500 | .341 | N/A | .312 | .315 | .130 |
| HI-518-WH | 5/16-18 | .500 | .403 | N/A | .374 | .378 | .177 |
| HI-524-WH | 5/16-24 | .500 | .403 | N/A | .374 | .378 | .177 |
| HI-316-WH | 3/8-16 | .500 | .494 | N/A | .465 | .469 | .236 |
| HI-324-WH | 3/8-24 | .500 | .494 | N/A | .465 | .469 | .236 |

* Hole size requirements may vary depending on a number of factors, including material and tools. We recommend that you test your particular application before ordering. We gladly supply free samples. "

STRAIGHT FLANGED

| Part Number. | Internal Thread | Overall Length (L+T) | Insert Diameter (W) | Head Diameter (H) | Pilot Diameter (N) | Rec. Hole Size* | Minimum Wall Thickness |
|--------------|-----------------|----------------------|---------------------|-------------------|--------------------|-----------------|------------------------|
| FL-256-HI | 2-56 | .178 | .141 | .187 | .123 | .126 | .051 |
| FL-440-HI | 4-40 | .250 | .181 | .218 | .154 | .157 | .063 |
| FL-632-HI | 6-32 | .311 | .214 | .250 | .185 | .189 | .071 |
| FL-832-HI | 8-32 | .357 | .248 | .281 | .218 | .220 | .083 |
| FL-124-HI | 10-24 | .418 | .278 | .312 | .249 | .252 | .102 |
| FL-132-HI | 10-32 | .418 | .278 | .312 | .249 | .252 | .102 |
| FL-420-HI | 1/4-20 | .553 | .341 | .375 | .312 | .315 | .130 |
| FL-428-HI | 1/4-28 | .553 | .341 | .375 | .312 | .315 | .130 |
| FL-518-HI | 5/16-18 | .553 | .403 | .437 | .374 | .378 | .177 |
| FL316-HI | 3/8-16 | .563 | .494 | .551 | .465 | .469 | .236 |

* Hole size requirements may vary depending on a number of factors, including material and tools. We recommend that you test your particular application before ordering. We gladly supply free samples.

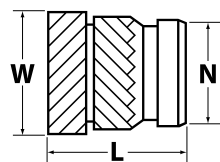

Flush

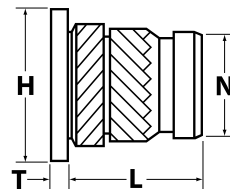

Flanged

FOR CORED OR DRILLED HOLES IN PLASTIC

Diamond-knurled press inserts are designed to replace molded-in inserts and threads in thermoset plastics.



- INSTALL COLD
- SHARPLY REDUCE THE COST OF MOLDINGS
- CUT REJECT WASTE CAUSED BY MISALIGNED AND FAULTY INSERTS
- ELIMINATE THE NEED TO "CHASE" THREADS AFTER MOLDING
- INSTALL PROPERLY WITHOUT A PRECISE HOLE DEPTH

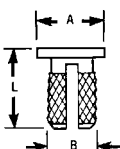
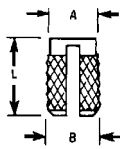
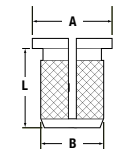
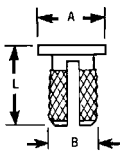
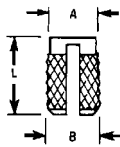

* Hole size requirements may vary depending on a number of factors, including material and tools. We recommend that you test your particular application before ordering. We gladly supply free samples.

BRASS — FLUSH

| EZ-LOK Part No. | Internal Thread | A ±.010" | B ±.010" | L ±.010" | Starting Hole Size* |
|-----------------|-----------------|-------------|-------------|-------------|---------------------|
| 240-000-BR | 0-80 | .094 | .104 | .125 | .094 (3/32) |
| 240-002-BR | 2-56 | .125 | .135 | .156 | .125 (1/8) |
| 240-004-BR | 4-40 | .156 | .166 | .188 | .156 (5/32) |
| 240-006-BR | 6-32 | .187 | .199 | .250 | .188 (3/16) |
| 240-008-BR.250 | 8-32 | .218 | .230 | .250 | .219 (7/32) |
| 240-008-BR | 8-32 | .218 | .230 | .313 | .219 (7/32) |
| 240-332-BR.250 | 10-32 | .250 | .262 | .250 | .250 (1/4) |
| 240-332-BR | 10-32 | .250 | .262 | .375 | .250 (1/4) |
| 240-3-BR | 10-24 | .250 | .262 | .375 | .250 (1/4) |
| 240-4-BR | 1/4-20 | .312 | .326 | .500 | .313 (5/16) |
| 240-5-BR | 5/16-18 | .375 | .389 | .563 | .375 (3/8) |
| 240-6-BR | 3/8-16 | .437 | .451 | .625 | .438 (7/16) |
| 240-M3-BR | M3-0.5 | .156 | .166 | .188 | .156 (5/32) |
| 240-M3.5-BR | M3.5-0.6 | .187 | .199 | .250 | .188 (3/16) |
| 240-M4-BR | M4-0.7 | .218 | .230 | .313 | .219 (7/32) |
| 240-M5-BR | M5-0.8 | .250 | .262 | .375 | .250 (1/4) |
| 240-M6-BR | M6-1.0 | .312 | .326 | .500 | .313 (5/16) |

BRASS — FLANGED

| EZ-LOK Part No. | Internal Thread | A ±.010" | B ±.010" | L ±.010" | Starting Hole Size* |
|-----------------|-----------------|-------------|-------------|-------------|---------------------|
| 260-002-BR | 2-56 | .187 | .135 | .156 | .125 (1/8) |
| 260-004-BR | 4-40 | .218 | .166 | .188 | .156 (5/32) |
| 260-006-BR | 6-32 | .249 | .199 | .250 | .188 (3/16) |
| 260-008-BR | 8-32 | .280 | .230 | .313 | .219 (7/32) |
| 260-332-BR | 10-32 | .312 | .262 | .375 | .250 (1/4) |
| 260-4-BR | 1/4-20 | .375 | .326 | .500 | .313 (5/16) |
| 260-5-BR | 5/16-18 | .437 | .389 | .563 | .375 (3/8) |
| 260-6-BR | 3/8-16 | .500 | .451 | .625 | .438 (7/16) |

BRASS — FLANGED — REVERSED SLOT

| EZ-LOK Part No. | Internal Thread | A ±.010" | B ±.010" | L ±.010" | Starting Hole Size* |
|-----------------|-----------------|-------------|-------------|-------------|---------------------|
| 260-002-RS | 2-56 | .187 | .135 | .156 | .125 (1/8) |
| 260-004-RS | 4-40 | .218 | .166 | .188 | .156 (5/32) |
| 260-006-RS | 6-32 | .249 | .199 | .250 | .188 (3/16) |
| 260-008-RS | 8-32 | .280 | .230 | .313 | .219 (7/32) |
| 260-332-RS | 10-32 | .312 | .262 | .375 | .250 (1/4) |
| 260-4-RS | 1/4-20 | .375 | .326 | .500 | .313 (5/16) |

STAINLESS STEEL — FLUSH

| EZ-LOK Part No. | Internal Thread | A ±.010" | B ±.010" | L ±.010" | Starting Hole Size* |
|-----------------|-----------------|-------------|-------------|-------------|---------------------|
| 240-002-CR | 2-56 | .125 | .135 | .156 | .125 (1/8) |
| 240-004-CR | 4-40 | .156 | .166 | .188 | .156 (5/32) |
| 240-006-CR | 6-32 | .187 | .199 | .250 | .188 (3/16) |
| 240-008-CR | 8-32 | .218 | .230 | .313 | .219 (7/32) |
| 240-332-CR | 10-32 | .250 | .262 | .375 | .250 (1/4) |
| 240-4-CR | 1/4-20 | .312 | .326 | .500 | .313 (5/16) |
| 240-5-CR | 5/16-18 | .375 | .389 | .563 | .375 (3/8) |
| 240-6-CR | 3/8-16 | .437 | .451 | .625 | .438 (7/16) |

STAINLESS STEEL — FLANGED

| EZ-LOK Part No. | Internal Thread | A ±.010" | B ±.010" | L ±.010" | Starting Hole Size* |
|-----------------|-----------------|-------------|-------------|-------------|---------------------|
| 260-002-CR | 2-56 | .187 | .135 | .156 | .125 (1/8) |
| 260-004-CR | 4-40 | .218 | .166 | .188 | .156 (5/32) |
| 260-006-CR | 6-32 | .249 | .199 | .250 | .188 (3/16) |
| 260-008-CR | 8-32 | .280 | .230 | .313 | .219 (7/32) |
| 260-332-CR | 10-32 | .312 | .262 | .375 | .250 (1/4) |
| 260-4-CR | 1/4-20 | .375 | .326 | .500 | .313 (5/16) |



External knife threads provide superior holding power in hard and soft woods, particle board and all wood products. Use wherever field assembly or disassembly could lead to thread erosion or stripping. The long pilot ensures straight driving into a drilled hole. Install with screwdriver, bolt and nut, tapping head, or E-Z LOK driving tool.



BRASS KNIFE THREAD INSERTS — FOR WOOD

| EZ-LOK Part No. | Internal Thread | Length | Major Diameter External Thread | Hole* Size | Drive Tool Catalog Number |
|-----------------|-----------------|--------|--------------------------------|------------|---------------------------|
| 400-004 | 4-40 | .375 | .350 | 1/4" | — |
| 400-006 | 6-32 | .375 | .350 | 1/4" | 500-006 |
| 400-008 | 8-32 | .375 | .350 | 1/4" | 500-1 |
| 400-3 | 10-24 | .500 | .453 | 3/8" | 500-2 |
| 400-332 | 10-32 | .500 | .453 | 3/8" | 500-2 |
| 400-4 | 1/4-20 | .500 | .453 | 3/8" | 500-3 |
| 400-428 | 1/4-28 | .500 | .453 | 3/8" | 500-3 |
| 400-5 | 5/16-18 | .625 | .600 | 1/2" | 500-4 |
| 400-524 | 5/16-24 | .625 | .600 | 1/2" | 500-4 |
| 400-6 | 3/8-16 | .625 | .600 | 1/2" | 500-5 |
| 400-624 | 3/8-24 | .625 | .600 | 1/2" | 500-5 |
| 400-M3 | M3-0.5 | .375 | .350 | 1/4" | 500-006 |
| 400-M4 | M4-0.7 | .375 | .350 | 1/4" | 500-1 |
| 400-M5 | M5-0.8 | .500 | .453 | 3/8" | 500-2 |
| 400-M6 | M6-1.0 | .500 | .453 | 3/8" | 500-3 |
| 400-M8 | M8-1.25 | .625 | .600 | 1/2" | 500-5 |

STAINLESS STEEL KNIFE THREAD INSERTS — FOR WOOD

| EZ-LOK Part No. | Internal Thread | Length | Major Diameter External Thread | Hole* Size | Drive Tool Catalog Number |
|-----------------|-----------------|--------|--------------------------------|------------|---------------------------|
| 400-008-CR | 8-32 | .375 | .350 | 1/4" | 500-1 |
| 400-3-CR | 10-24 | .500 | .453 | 3/8" | 500-2 |
| 400-4-CR | 1/4-20 | .500 | .453 | 3/8" | 500-3 |

*Hole size requirements may vary depending on material and tools. We recommend that you test before ordering. We gladly supply free samples.



DIE CAST ZINC ALLOY HEXDRIVE THREAD INSERTS — FOR WOOD

| EZ-LOK Part No. | Design | Internal Thread | Length | Hole* Size | Hex Dimensions | Drive Tool. Catalog Number |
|-----------------|---------|-----------------|--------|------------|----------------|----------------------------|
| 800832-10 | Flush | 8-32 | 10mm | 6mm | M4 | 8500 |
| 801024-13 | Flush | 10-24 | 13mm | 7mm | M5 | 8600 |
| 801032-13 | Flush | 10-32 | 13mm | 7mm | M5 | 8600 |
| 801420-13 | Flush | 1/4-20 | 13mm | 9mm | M6 | 9000 |
| 801420-20 | Flush | 1/4-20 | 20mm | 9mm | M6 | 9000 |
| 851618-20 | Flush | 5/16-18 | 20mm | 11mm | M8 | 9100 |
| 851618-25 | Flush | 5/16-18 | 25mm | 11mm | M8 | 9100 |
| 800610-13 | Flush | M6-1.0 | 13mm | 9mm | M6 | 9000 |
| 800610-20 | Flush | M6-1.0 | 20mm | 9mm | M6 | 9000 |
| 808125-13 | Flush | M8-1.25 | 13mm | 11mm | M8 | 9100 |
| 808125-20 | Flush | M8-1.25 | 20mm | 11mm | M8 | 9100 |
| 900832-10 | Flanged | 8-32 | 10mm | 6mm | M4 | 8500 |
| 901024-11 | Flanged | 10-24 | 11mm | 7mm | M5 | 8600 |
| 901024-20 | Flanged | 10-24 | 20mm | 7mm | M5 | 8600 |
| 901032-11 | Flanged | 10-32 | 11mm | 7mm | M5 | 8600 |
| 901032-13 | Flanged | 10-32 | 13mm | 7mm | M5 | 8600 |
| 901032-20 | Flanged | 10-32 | 20mm | 7mm | M5 | 8600 |
| 901420-13 | Flanged | 1/4-20 | 13mm | 9mm | M6 | 9000 |
| 901420-20 | Flanged | 1/4-20 | 20mm | 9mm | M6 | 9000 |
| 901420-25 | Flanged | 1/4-20 | 25mm | 9mm | M6 | 9000 |
| 951618-13 | Flanged | 5/16-18 | 13mm | 11mm | M8 | 9100 |
| 951618-25 | Flanged | 5/16-18 | 25mm | 11mm | M8 | 9100 |
| 903816-13 | Flanged | 3/8-16 | 13mm | 12mm | M10 | 9200 |
| 903816-25 | Flanged | 3/8-16 | 25mm | 12mm | M10 | 9200 |
| 900610-13 | Flanged | M6-1.0 | 13mm | 9mm | M6 | 9000 |
| 900610-20 | Flanged | M6-1.0 | 20mm | 9mm | M6 | 9000 |
| 908125-13 | Flanged | M8-1.25 | 13mm | 11mm | M8 | 9100 |
| 908125-20 | Flanged | M8-1.25 | 20mm | 11mm | M8 | 9100 |

An inexpensive insert for use in ready-to-assemble furniture, drawer pulls and wherever ease of assembly or avoidance of thread stripping is desired. Install with hex drive wrench or E-Z LOK drive tool.



*Hole size requirements may vary depending on material and tools. We recommend that you test before ordering. We gladly supply free samples.

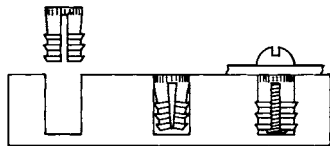

Finseks provide strong metal threads in wood, composition board and thermoplastics such as nylon, polystyrene, cellulose acetate and cycloc. By distributing stress over a greater surface area, firm permanent fastening is ensured. The fins give higher holding strength in softer materials. Available with one, two or three fins for varying material thickness, Finseks prevent splintering, splitting and thread pullout.

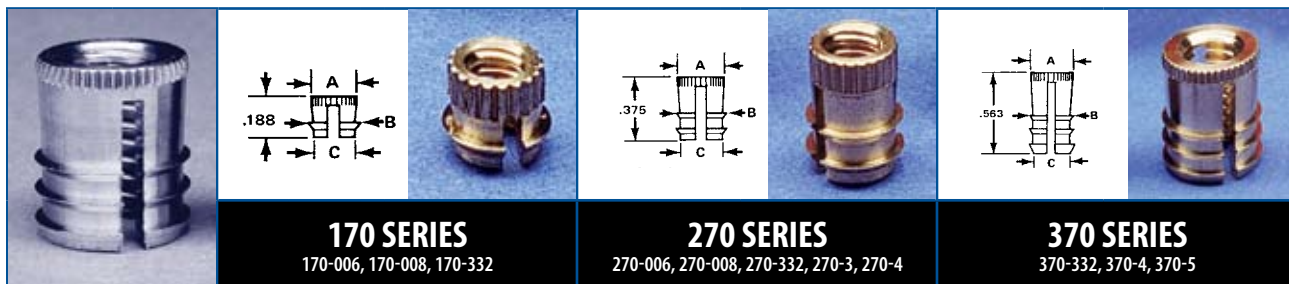

| Thread Size | Dash Number | A | B | C | Starting Hole Size | A | B | C | Starting Hole Size | A | B | C | Starting Hole Size |
|-------------|-------------|------|------|------|--------------------|------|------|------|--------------------|------|------|------|--------------------|
| 6-32 | —006 | .210 | .237 | .189 | .205 (#5) | .210 | .237 | .189 | .205 (#5) | — | — | — | — |
| 8-32 | —008 | .236 | .263 | .215 | .234 (15/64) | .236 | .263 | .215 | .234 (15/64) | — | — | — | — |
| 10-32 | —332 | .263 | .290 | .242 | .261 (G) | .263 | .290 | .242 | .261 (G) | .347 | .368 | .318 | .344 (11/32) |
| 10-24 | —3 | — | — | — | — | .263 | .290 | .242 | .261 (G) | — | — | — | — |
| 1/4-20 | —4 | — | — | — | — | .330 | .357 | .309 | .328 (21/64) | .409 | .431 | .381 | .406 (13/32) |
| 5/16-18 | —5 | — | — | — | — | — | — | — | — | .471 | .493 | .443 | .469 (15/32) |

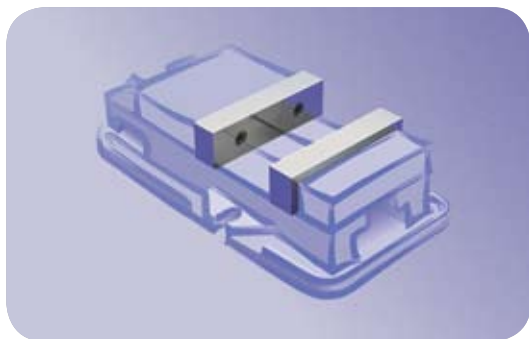

TCI ALUMINUM SOFT JAWS

| Part Number | Vise Size | Jaw Dimensions | | |
|-------------|-----------|----------------|-------|--------|
| | | T(“)* | H(“) | L(“) |
| 1610-3 | 3” | .730 | 1.250 | 4.000 |
| 1610-4 | 4” | .980 | 1.500 | 5.000 |
| 1610-5 | 5” | 1.230 | 1.750 | 6.000 |
| 1610-6 | 6” | 1.230 | 2.000 | 7.000 |
| 1610-8 | 8” | 1.730 | 2.500 | 9.000 |
| 1610-10 | 10” | 2.230 | 3.500 | 11.000 |

*All dimensions +/- .001”

FOR PRECISION MACHINE VISES

• HIGH PRECISION JAWS

Aircraft alloy aluminum flat and parallel within .001”.

• SAVE ON EXPENSIVE FIXTURES

Easy to customize jaws for mill or drill features.

• SAVE SET-UP TIME WHEN CHANGING JOBS

Leave vise on table...Remove 4 cap screws... Replace TCI Aluminum Soft Jaws...minimize set-up time.

• REUSABLE JAWS

Easy-to-machine aluminum allows inexpensive modifications.

• GET 2 FIXTURES FOR THE PRICE OF 1

Inverting jaws permits second fixture on the same pair of jaws.

• GENEROUS SIZE

Allows greater flexibility when building tooling.

• PROTECT FINISH

Aluminum Soft Jaws will not damage finish of parts.